

IMPORTANT:

If any fixings are supplied with the unit, Installers must ensure these are appropriate for the chosen substrate or use a suitable alternative.

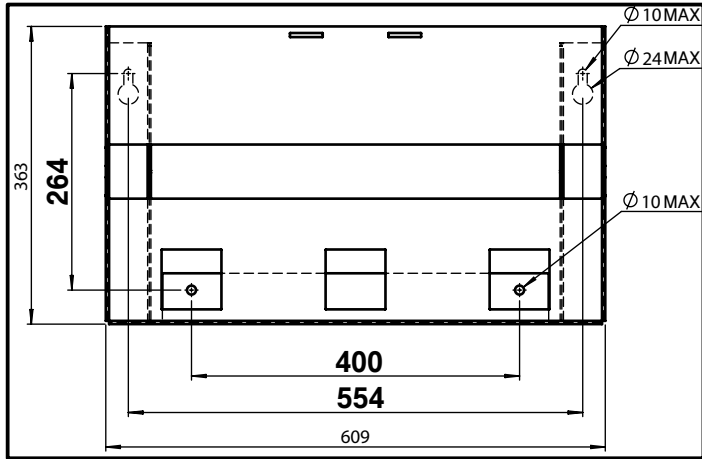

1. Hold the unit up to the wall, level the unit, and mark the position of the holes, or use the above fixings diagram. (A card template can also be used.)

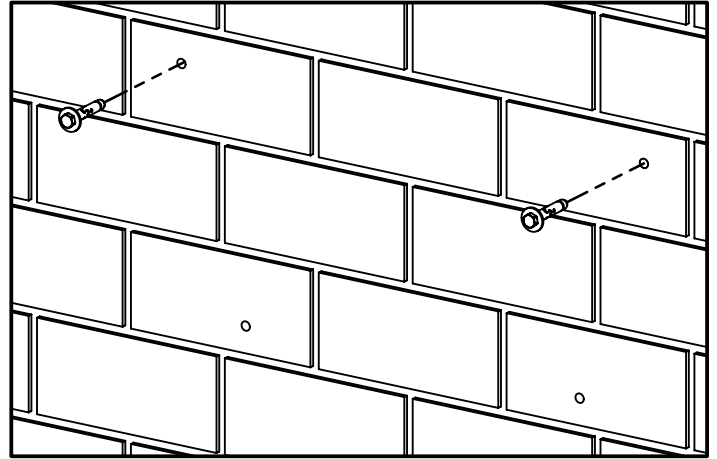

2. Drill four holes in the wall for the fixings as per the fixing manufacturers instructions and fit two fixings into the upper holes only.

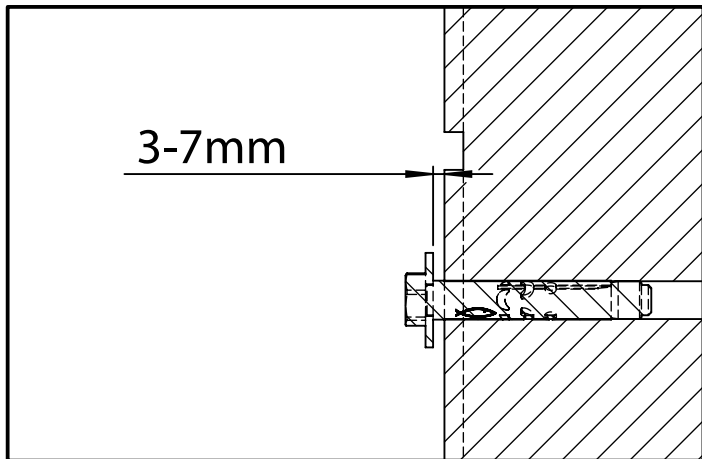

3. Unscrew the two bolts approx 3-7mm max.

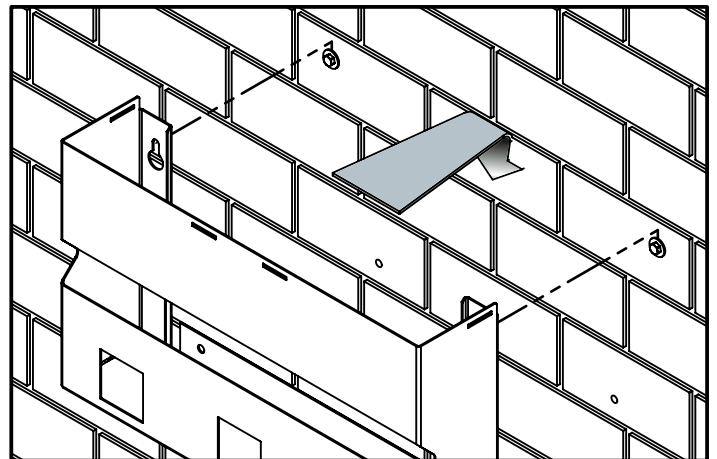

3. Hook the bayonet holes over the washers of the two upper bolts and tighten slightly. (these MUST be fully tightened shortly), this allows adjustments to be made when lining up the two lower bolts.

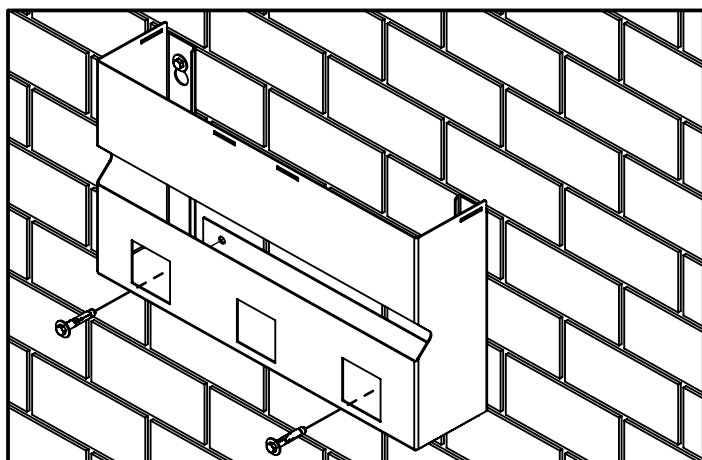

4. Fit two bolts through the lower holes in the back of the case. Now FULLY TIGHTEN ALL 4 BOLTS, checking that the unit is level.

NOTE: If you struggle to fit the case over the washers it may be easier to pre-fit the bolts through the case then offer up the case plus bolts to the wall together.



5. Lower the napkin section into place ensuring the finger holes are uppermost. Slide in the mid-section sachets dispenser with the front lip on the OUTSIDE of the unit (as shown). Place the Saucestation lid on top, ensuring it locates into the slot at the back of the unit. After wiping down the unit it can be filled: Napkins from the front, and sachets from the top.